

U-STUCCO™ ASSEMBLY

ICF (INSULATED CONCRETE FORM)



DETAIL #004

V.22-0413

CONCRETE

CONCRETE SHALL BE ALLOWED TO CURE FOR A MIN OF 28 DAYS PRIOR TO APPLICATION OF U-STUCCO™ XPX or HPX

ICF

INSULATED CONCRETE FORM

BY NUDURA,
FOX BLOCKS,
BUILD BLOCK,
QUADLOCK,
AMVIC,
INTEGRASPEC,
LITEFORM,
SUPER FORM,
OMNI BLOCK,
PERFECT BLOCK.

RASPED SURFACE

RASPING THE FOAM SURFACE TO PROVIDE A LEVEL SURFACE FOR COATINGS SHALL NOT EXPOSE FORM TIES

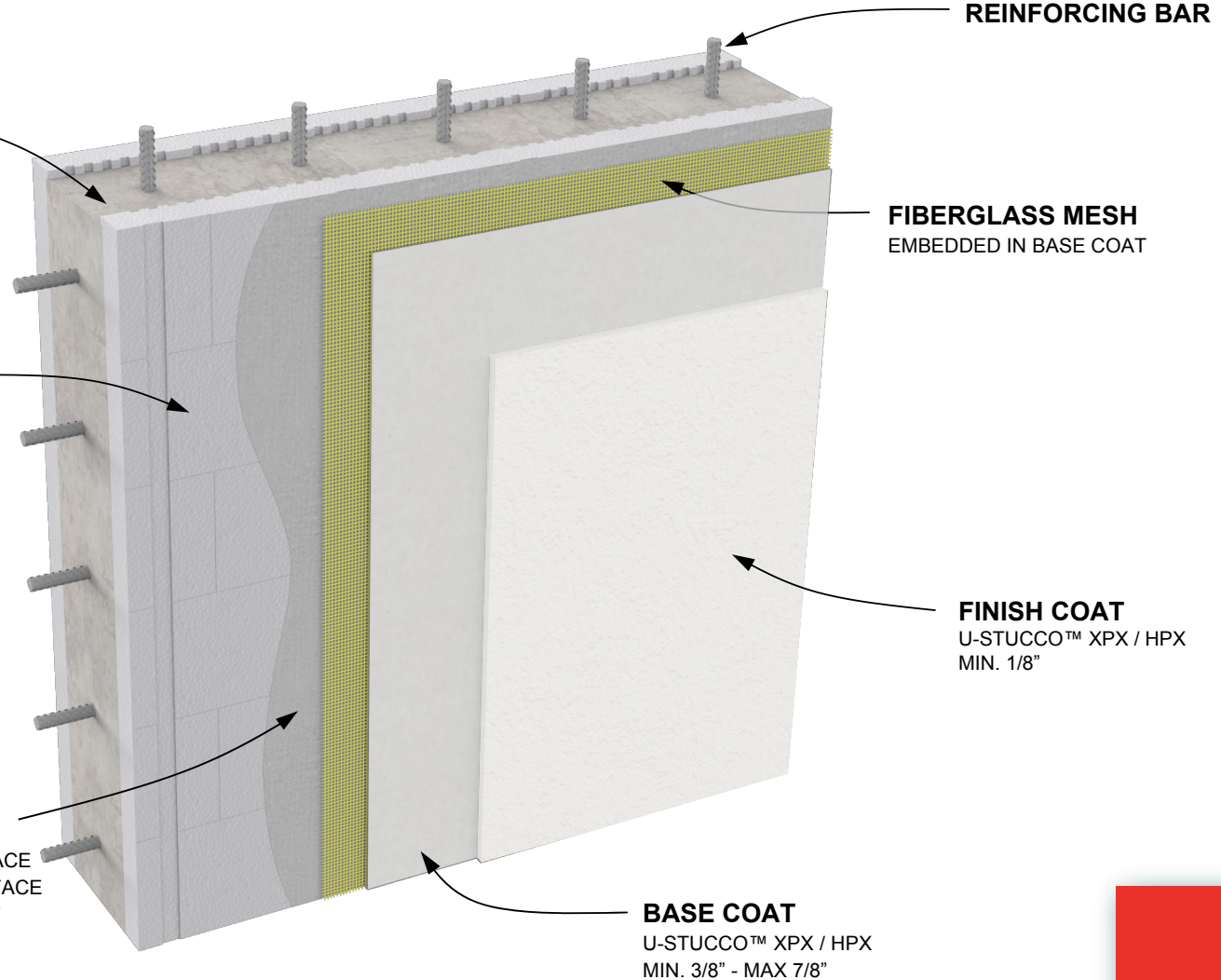

REINFORCING BAR

FIBERGLASS MESH
EMBEDDED IN BASE COAT

FINISH COAT
U-STUCCO™ XPX / HPX
MIN. 1/8"

BASE COAT
U-STUCCO™ XPX / HPX
MIN. 3/8" - MAX 7/8"

Disclaimer : The design specifications and construction shall comply with all local building codes and standards. U-STUCCO™ installation guidelines are for general information and guidance only and U-STUCCO™ specifically disclaims any liability for the use of this design, and for design engineering, or workmanship of any project. The assembly shall be designed to prevent condensation within the assembly. Products shown other than those manufactured by U-STUCCO™ are shown for the clarity of the U-STUCCO™ products only. Contact the Manufacturer for installation instructions.

Technical Support : (424) 542-5353 | info@ustucco.com

